



COMPANY PROFILE

---



Engineering  
*your*  
Vision

**Onna Engineering** was established in Istanbul-Turkey as a base of operations to launch into the growing construction markets with deep experience in **Electrical Engineering and Contracting Services**.

Onna's foundation is based on proved project engineering methods and experienced site teams. Onna today operates using the same electrical contracting and management standards which continue to deliver success for all our clients. With growing necessity to deliver high quality yet cost effective engineering and installation solutions to the market. Onna is well positioned to over a range of engineering and installation services to all our clients combined with the talented management and installation teams that ensure successful delivery of all our projects. From this successful and solid foundation, Onna continues to combine the best installation, engineering and management practices to over a range of solutions which continues to drive Onna's emergence as a significant force in the construction industry to help designers, construction companies and investors.



Zero harm target is our #1 priority for all people and environment

## Health, Safety and Environment

The safety of our workforce is the most important aspect of our business, no exception.

**Onna** aims to stay at the fore front of the industry and have adopted and developed HSE policies and management practices that sees the quality control of every task. Our Safety systems are in accordance with ISO 45001 and they are instilled into our employees ensuring that our work is completed with zero harm as our #1 priority.

**Onna** is committed to ensuring that our operations are conducted with zero harm to all people and the environment and the quality of our products and services are upheld and consistently maintained.



**ZERO HARM**

We empower our people to:

- Intervene when they witness any 'at-risk' behavior
- Lead by example
- Identify and manage hazards associated with the activities for which they are responsible
- Courageously and honestly report all accidents and hazards
- Take the time to do things right; do the job safely or not at all – do not cut corners

## Core Values of Onna

### Young with Heart, Full of Tradition

The strength and success of Onna is in the projects that have been completed around the world which have sparked the passion for achieving excellence.

Onna has extensive electrical engineering and project delivery experience in commercial, institutional and aviation sector.

With a large electrical engineering capability Onna is able to cover all clients a complete electrical project services, along with value engineering, feasibility studies , project management , installation and hand-over.

With dedication to being a socially responsible company, all of Onna's processes and ethos are focused on operating in a conscientious manner. Onna is committed to our fundamental values and takes extensive steps to ensure that the entire Onna team adheres to a strict code of business ethic.

## Mission and Vision

Our global strategy can be successful only with dedicated people who have a vision and mission in their mind.

Onna vision is to be recognized across the region as the most progressive Electrical Engineering management and contracting company.

Our mission is to be an regional market leader in the Electrical Engineering and contracting industry through implementing intelligent systems and challenging the limits of construction speed and efficiency while maintaining the highest levels of quality and safety.

## Our HSE Culture

All of our themes have supporting behaviors. The 'everyone' behaviors apply to all people regardless of their role. The application of these behaviors will ensure that together we achieve alignment of policy, process and actions, which we regard as key to realizing our target of zero harm.





# Three Business Domains

## Commercial Institutional Aviation

Contracting Capabilities

Onna provides full electrical contracting services, starting from engineering, budgeting, planning to installation, testing, commissioning and maintenance works. Our dedicated team of multi-disciplined, highly qualified engineers, technical staff, administrative personnel and site installation teams means Onna provides high quality project management, engineering, workmanship and complete projects on time and within budget.

This professional success combined with our personal approach has won us a consistently high level of repeat business over the past two decades, with a continually expanding client base of prestigious national and international organizations .



Sheraton Hotel, Bamako Mali

## Commercial

Onna Engineering works alongside industry-leading construction companies in providing electrical contracting services for hotels, shopping malls, offices, residential complexes, sport venues etc. Our firm is involved in a wide spectrum of standard and specialized Electrical systems design and installation for commercial projects.

Onna Engineering electrical contracting services to the sectors encompasses

### Pre & Post Installation Services

- Project Planning
- System Analysis
- Budget Preparation
- Controlling the design drawings and cooperate with consultants to make necessary design changes in the perspective of regulations and/or requirements.
- Meeting with client representatives, presentation of the systems, getting approvals, making system and/or drawing modifications based on requirements.



- Preparation of the procurement lists, technical negotiation with potential suppliers in the perspective of project schedule and technical requirements.
- Making technical follow-up works with local electrical company to get permanent energy to the premises.
- Preparing Shop drawings.
- Preparing As-Build drawings and Handover documents.

## Commercial



## Institutional



## Aviation





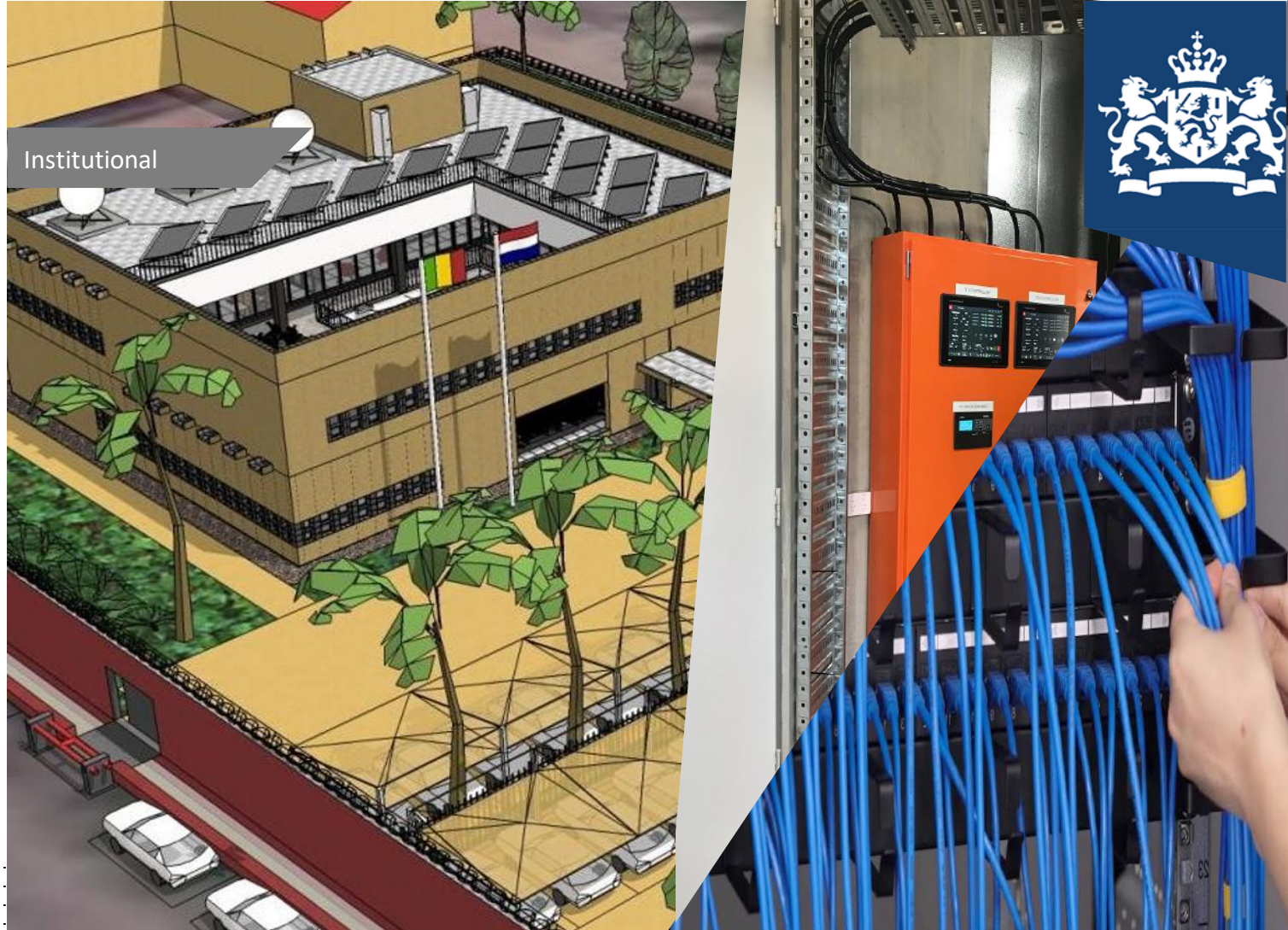

Institutional

Royal Dutch Embassy , Bamako Mali



Aviation

Istanbul New Airport, Istanbul Turkey

## Institutional

Recognized as one of international Turkish leading electrical contractors, **Onna Engineering** delivers high quality contracting outcomes for international government facilities, embassies, schools, airports.

Onna Engineering electrical contracting services to the sectors encompasses

### Project Management and Installation Services

- Medium Voltage System installation
- Transformer System installation
- Generator System installation
- Synchronization System installation
- UPS System installation
- Power Distribution System (cabling, conduits, trays etc.) installation



- Electrical Panels installation
- Sockets and Outlets installation
- Electrification of the HVAC and Plumbing Equipment
- Lighting fixtures installation
- Lightning and Earthing System installation
- Data and Network System
- Telephone System

## Aviation

Our aviation contracting services for installation of Gate solutions and apron management ranges from installation of docking guidance systems, steel structures, physical design and all related electrical and extra low voltage infrastructure solutions.

Onna Engineering electrical contracting services to the sectors encompasses

### Project Management and Installation Services

- Fire Detection System
- Access Control System
- IP CCTV System
- Lighting Control System
- Background Music and Announcement System
- Professional Audio and Video Systems
- IP TV System



- Guest Room Energy Management System
- Server System, firewalls etc.
- Office operational equipment (PC's Printers etc.)
- PMS system
- VDGS System
- Energy metering system
- Testing, commissioning and training of the systems



## Onna's Global Expansion



Growth is never by mere chance; it is the result of forces working together

Onna is focused on delivering high quality electrical contracting services across all international markets. Onna currently has operations in Turkey, Africa and Middle East.

Onna continues to focus on growth in international market coverage with a committed focus to expanding throughout all region for to keep helping our clients to be successful in their project challenges.



## Management Policy of Onna

Total confidence of our associates in all business transactions

Total confidence of our clients to use of all our services

Total confidence of our employees in all their efforts

## Quality Policy of Onna

Onna has earned global recognition for our total quality management

Onna acquired an international standard certification for the ISO9001 quality management system. Our total quality management from engineering, installation to maintenance has earned global recognition.







Lounge



Rooms



Lobby



Conference Hall



Exhibition and Wedding Hall

Hotel 2 Fevrier, Lome Togo

**Radisson Hotel 2 Fevrier**  
(Hospitality)

This project is one of the most challenging project in Onna History. Our client has requested a brand-new hotel from a historical old building "Hotel 2 Fevrier". Onna has completed successfully this transformation and as a result one of the leading hotel of West Africa.

Project Information

- 60.000 m2
- 256 Rooms
- 33 Floors
- 64 Serviced Apartments
- 2015-16

Technical Scope

- Generator System installation
- Synchronization System installation
- UPS System installation
- Power Distribution System (cabling, conduits, trays etc.) installation
- Electrical Panels installation
- Sockets and Outlets installation
- Electrification of the HVAC and Plumbing Equipment
- Lighting fixtures installation
- Lightning and Earthing System installation
- Data and Network System
- Telephone System
- Fire Detection System
- Access Control System
- IP CCTV System
- Lighting Control System
- Background Music and Announcement System
- Professional Audio and Video Systems
- IP TV System

Highest in West Africa



**Sheraton Hotel** is the leading hotel of Mali. Onna Engineering has given full electrical contracting services from design to completion. It is one of the milestone project for Onna which shows company capability to work fully integrated with local and international regulations in parallel with operator requirements in Africa.

Project Information  
16.000 m2  
200 Rooms  
2016-17

- Medium Voltage System installation
- Transformer System installation
- Generator System installation
- Synchronization System installation
- UPS System installation
- Power Distribution System (cabling, conduits, trays etc.)
- Electrical Panels installation
- Sockets and Outlets installation
- Electrification of the HVAC and Plumbing Equipment
- Lighting fixtures installation
- Background Music and Announcement System
- Professional Audio and Video Systems
- IP TV System
- Guest Room Energy Management System
- Server System, firewalls etc.
- Office operational equipment (PC s Printers etc.)
- PMS system

**Novotel Cotonou Orisha** is one of the newest hotel in Cotonou ,Onna has provided full electrical contracting services and completed the project successfully .

Project Information  
9.000 m2  
110 Rooms  
2018-19



- UPS System installation
- Power Distribution System (cabling, conduits, trays etc.)
- Electrical Panels installation
- Sockets and Outlets installation
- Electrification of the HVAC and Plumbing Equipment
- Lighting fixtures installation
- Professional Audio and Video Systems
- Energy metering system
- Lightning and Earthing System installation
- Data and Network System
- Telephone System
- Fire Detection System
- Access Control System
- CCTV System
- Background Music and Announcement System



**New Istanbul Airport** -Onna Engineering has ongoing activities started from 2015 to help airports for their Gate-Apron solutions installation projects. Onna has completed visual docking guidance system installation projects in all region including **New Istanbul Airport, International Baku Airport, Ankara Esenboğa Airport, Istanbul Sabiha Gökçen Airport, Izmir Adnan Menderes Airport.**

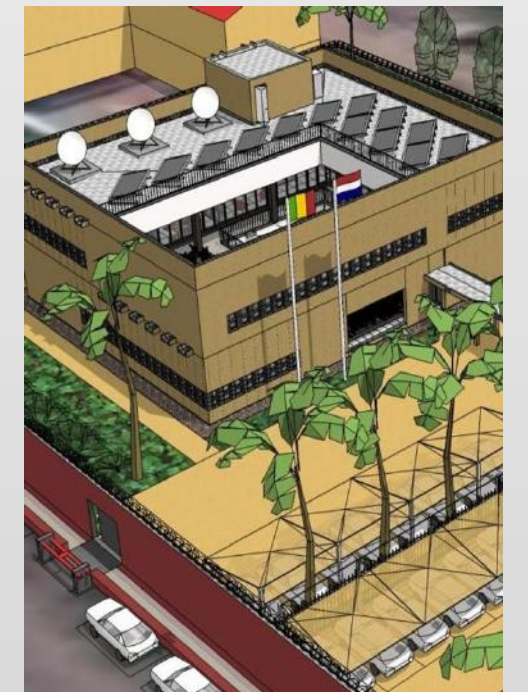

Project Information  
2.000 m2  
2019-19

**Royal Dutch Embassy Bamako Mali**

Onna Engineering is providing services to governments needs in international market. Onna Engineering has ongoing close relation with Dutch foreign ministry and our aim is to establish that relation more and more.

- Generator System Installation
- Power Distribution System (cabling, conduits, trays etc.)
- Electrical Panels installation
- Sockets and Outlets installation
- Electrification of the HVAC and Plumbing Equipment
- Lighting fixtures installation
- Energy metering system
- Lightning and Earthing System installation
- Data and Network System
- Telephone System infrastructure
- Fire Detection System infrastructure
- Access Control System infrastructure
- CCTV System infrastructure
- TV System infrastructure



www.onnaengineering.com